

SCALE 1/4

Specification :

Material :

1. Base Case : SECC, 1.5 mm thickness with Black/Gray color painted.
2. RJ45 Jack Housing : PBT+15%, UL 94V-0.
3. RJ45 Shield : Phosphor Bronze with Nickel plated.
4. RJ45 Jack Contact Material & Finished :
  - 4-1. Phosphor Bronze, Round Pin.
  - 4-2. Min. 50 micro-inch Gold plating over 50-60 micro-inch Nickel plated.
5. IDC Housing : PC+5%, UL 94V-2.
6. IDC Terminal material & finished :
  - 6-1. Phosphor Bronze with 50-60 micro-inch Tin plated.
  - 6-2. Krone tool only.
  - 6-3. Suitable for 22-26 AWG stranded and solid wire.
7. Ground Wire : 18 AWG Wire, with Green/Yellow striped color, length 40 cm.

Performance :

- a. The sticker color codes combine two wirings of T568A & T568B.
- b. Insertion Force : 900 gms for 8 contacts.
- c. Retention Strength : 7.7 kgs between Jack and Plug.
- d. Operation Temperature : -40°C to 80°C.
- e. Durability :
  - e-1. Jack : 750 cycles Plug-Jack mating and unmating test, insertion cycles at 20 cycles/minute max. Contact resistance test per 100 cycles.
  - e-2. IDC : Max. 200 punching times.
- f. The Cat.5e performance is in compliance with the ANSI/TIA/EIA 568 B.2 standard.

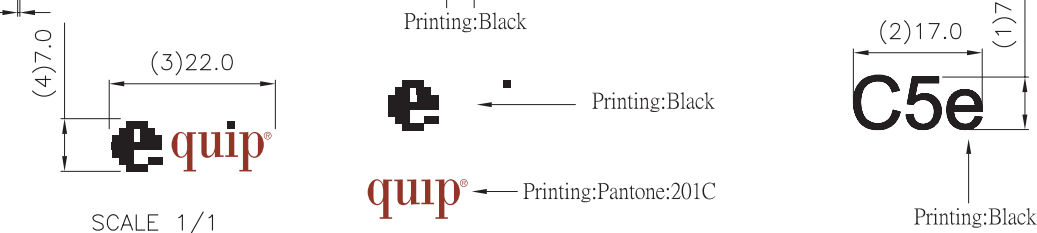
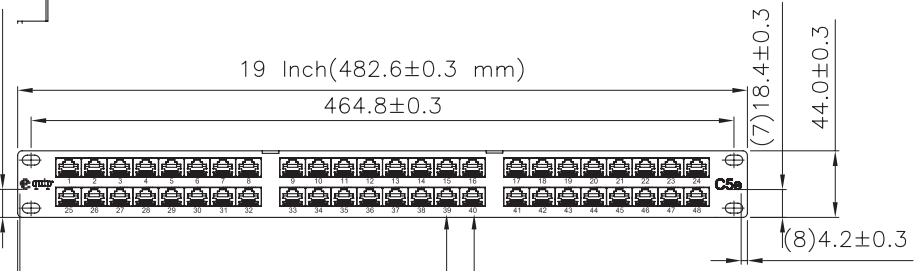
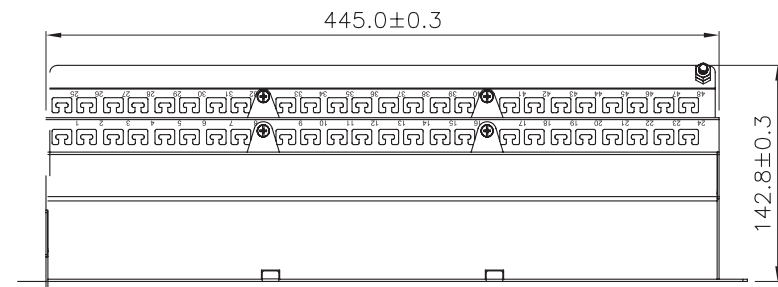
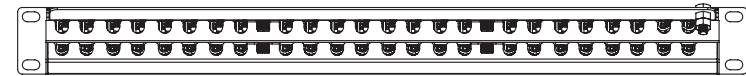
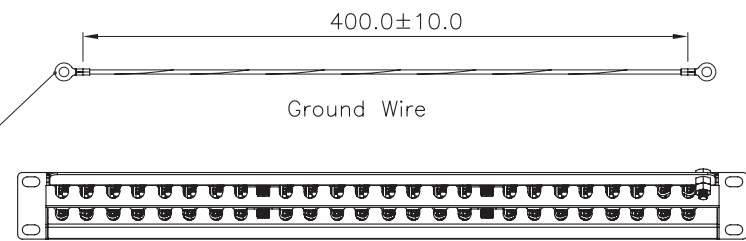

SCALE 1/1

GENERAL TOLERANCE OF DIMENSIONS	
X.XXX	±0.005
X.XX	±0.05
X.X	±0.1

**quip**

Cat.5e patch panel 48-Port, 1U, shielded, light grey

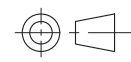

SCALE	1/5 (A4)	UNIT	mm	SHEET	1 OF 1	A1
-------	----------	------	----	-------	--------	----